



907/97-99 John Whiteway Drive GOSFORD NSW

2 2 2

Situated on the 9th floor of one of Gosford's most recognisable buildings, 'Mariner's View', and located just outside the ever-evolving CBD, this two bedroom apartment showcases expansive, uninterrupted views over Brisbane Water and beyond.

The apartment has an open plan kitchen, living and dining space that opens out, through glass sliding doors, to one of the balconies. The spacious kitchen has stone benchtops, stainless-steel appliances and an electric cooktop, and the large windows allow abundant natural light into the space.

Both bedrooms have access to a second balcony, the master suite has two built-in robes and an ensuite and the main bathroom has a separate bath and shower. A secure

[For full version visit the website](https://www.gittoes.com.au)

Type : Apartment
Price : \$ 820,000
Building Size : 96 sqm
Land Size : 186 sqm
View : <https://www.gittoes.com.au/sale/nsw/central-coast-region/gosford/residential/apartment/6594799>



Richard Faulkner
02 4323 1764



Matt Gravas
02 4323 3811

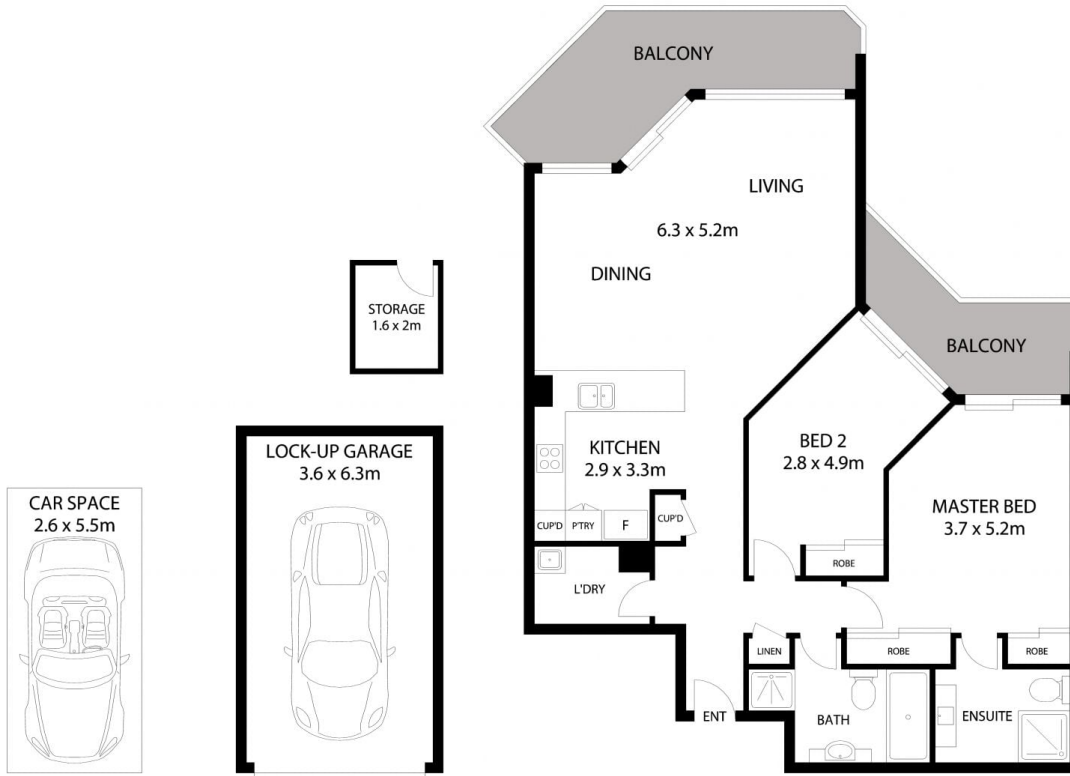

All dimensions herein are approximate and gathered from sources believed to be reliable. Whilst every effort is made for the accuracy of our floor plans, interested parties should rely on their own enquiries.



907/97-99 JOHN WHITEWAY DRIVE,
GOSFORD



Internal Area: 96m²
External Area: 50m²